

Read the complete test procedure, including recommended QC procedures before performing the test. Refer to the package insert for complete information about the test. Ensure ALL components are at room temperature (15–30 °C) when running the test.

Sample preparation

- 1 Gather test materials and label test device with specimen ID.
- 2 Remove cap from extraction reagent tube.
- 3 Tilt the patient's head back 70 degrees. While gently rotating the swab, insert swab less than one inch (about 2 cm) into nostril. Rotate the swab 5 times against the nasal wall then slowly remove from nostril.
- 4 Insert patient sample swab and vigorously plunge the swab up and down for 15 seconds.

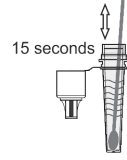
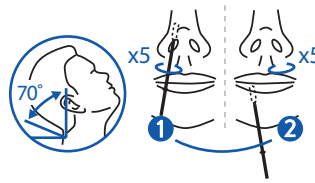
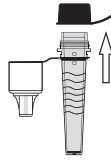
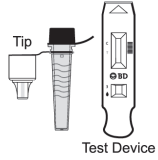

- 5 Remove swab while squeezing tube to extract liquid. Properly dispose of swab.
- 6 Press dispensing tip on the tube firmly. Mix the sample by flicking or swirling the bottom of the tube.

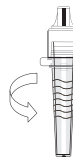
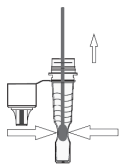

Using the BD Veritor Plus Analyzer to read the assay device

ANALYZE NOW MODE

- 7 Add 3 drops of the processed sample to the test device sample well.

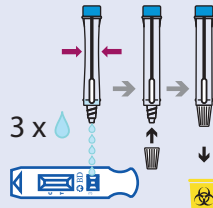

- 8 Allow test to develop for 15 minutes.
CAUTION: Incorrect results may occur if development time is less than 15 minutes. Cover test device if working in a drafty environment.



- 9 Test Interpretation (Refer to Figure)
 1. Negative result: The presence of only the control line (C) and no test line (T) within the result window indicates a negative result.
 2. Positive result: The presence of the test line (T) and the control line (C) within the result window, regardless of which line appears first, indicates a positive result.
Caution: The presence of any test line (T), no matter how faint, indicates a positive result.
 3. Invalid result: If the control line (C) is not visible within the result window after performing the test, the result is considered invalid.

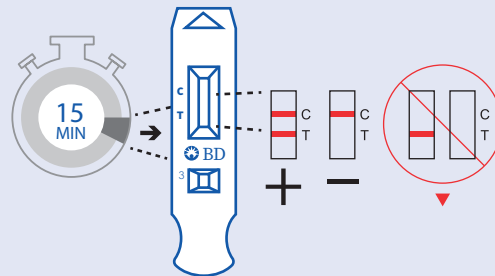

- 10 Record result, discard test device properly.



- 11 If you realize a positive result follow up with your local Health Care Professional for a follow-up confirmatory molecular test.